

LAKE SURVEY MAP

TUMA LAKE
MANITOWOC COUNTY
SEC. 17 T. 21 N. R. 23 E

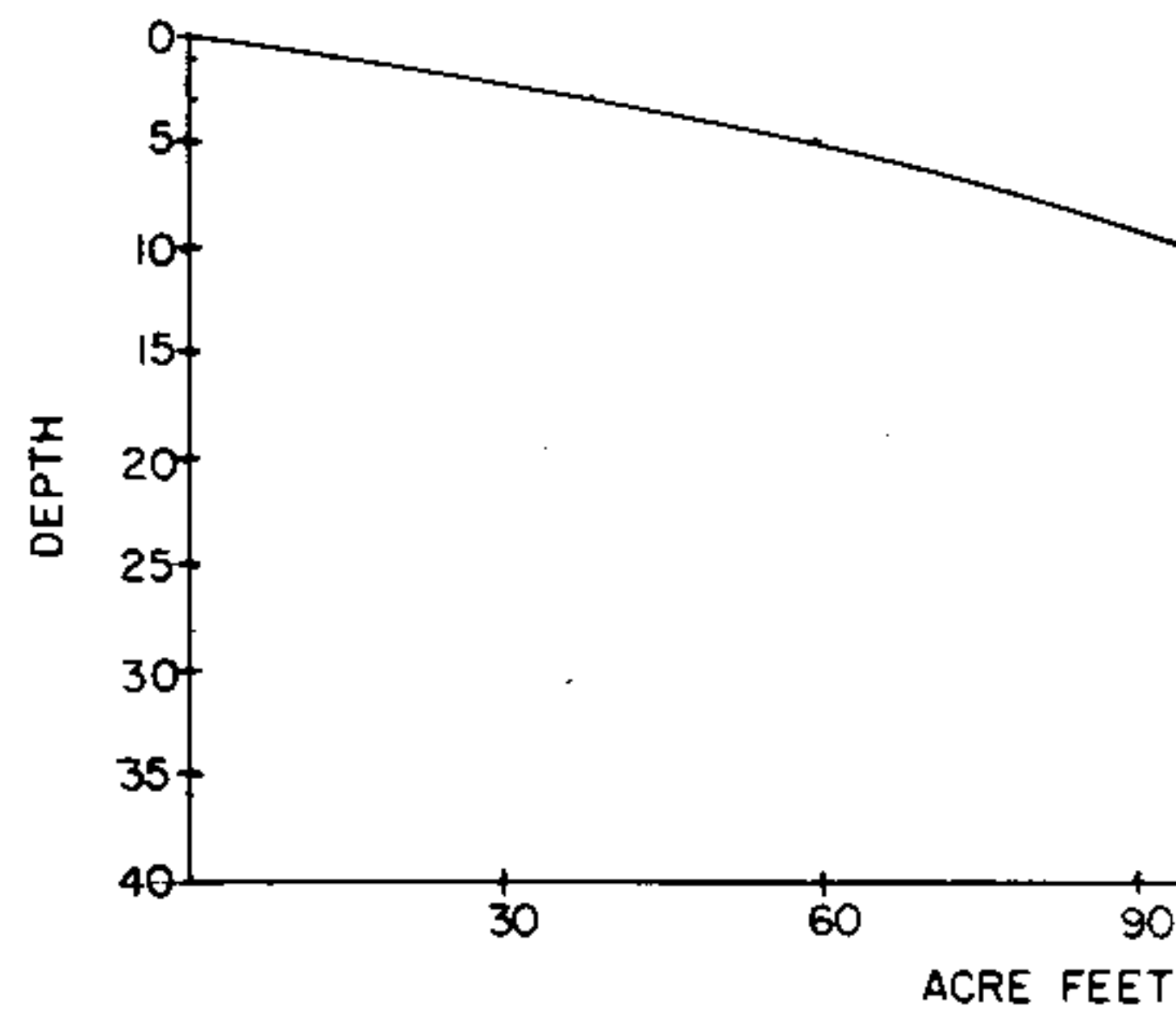
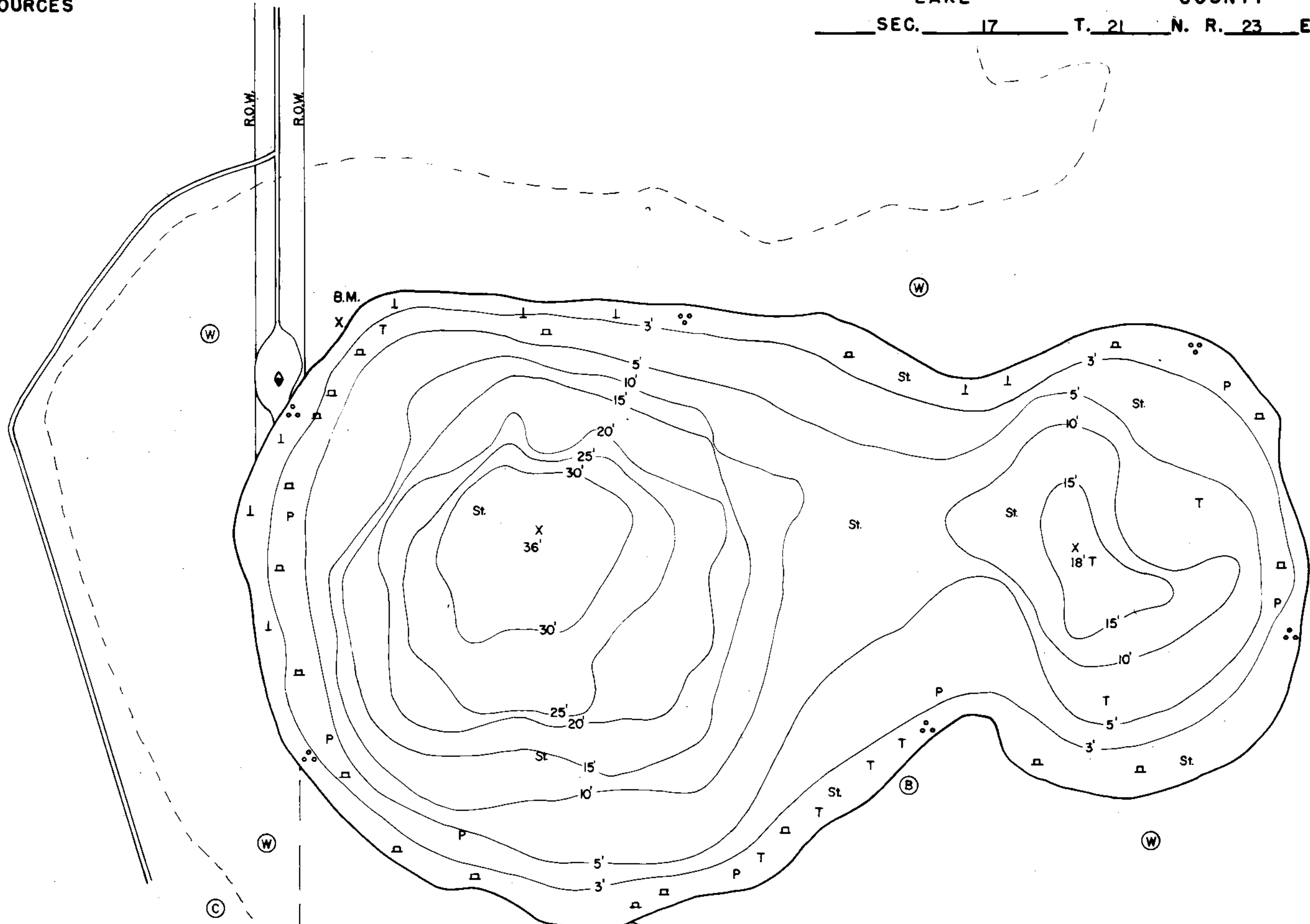

SW 1/4 Sec. 17
NW 1/4 Sec. 20

SE 1/4 Sec. 17
NE 1/4 Sec. 20

B.M. 'X' is a 1-3/4" pipe along shoreline on E. side of public landing on NW. end of lake.
Assumed Elev. 100.00
Water Elev. 97.10

Larrabee 2 Miles

EQUIPMENT RECORDING SONAR MAPPED AUGUST 1973

TOPOGRAPHIC SYMBOLS		LAKE BOTTOM SYMBOLS	
(B) Brush	Steep slope	P. Peat	B Boulders
(PW) Partially wooded	----- Indefinite shoreline	Mk. Muck	⊙ Stumps & Snags
(W) Wooded	----- Marsh	C. Clay	⊙ Rock danger to navigation
(C) Cleared	----- Spring	M. Marl	T Emergent vegetation
(P) Pastured	----- Intermittent stream	Sd. Sand	⊥ Submergent vegetation
(A) Agricultural	----- Permanent inlet	St. Silt	⊥ Floating vegetation
B.M. Bench Mark	----- Permanent outlet	Gr. Gravel	⊥ Brush shelters
■ Dwelling	----- Dam	R. Rubble	
■ Resort	----- D.N.R. State owned land	Bc. Bedrock	
■ Camp			



Access Access with Parking Boat Livery

Drawn by: J. Kushn
Field work by: D. Boese, B. L. O'Brien

SPECIES OF FISH	Abundance		
	Abundant	Common	Present
Muskie			
N. Pike			X
Walleye			X
L. M. Bass			X
S. M. Bass			X
Panfish	X		
Trout			

WATER AREA 13.9 ACRES
UNDER 3 FT. 14 %
OVER 20 FT. 14 %
MAX. DEPTH 36 FEET.
TOTAL ALK. 103 P.P.M.
VOLUME 148.0 ACRE FT.
SHORELINE 60 MILES

Source: Wisconsin Department of Natural Resources 608-266-2621
Tuma Lake – Manitowoc County, Wisconsin DNR Lake Map
Date – Aug 1973 - Historical Lake Map - Not for Navigation
A Public Document - Please Identify the Source when using it.