

B.M. X' top of iron pipe by iron fence post  
20' from lake.  
Assumed elevation 100.00'  
Water elevation 95.20'

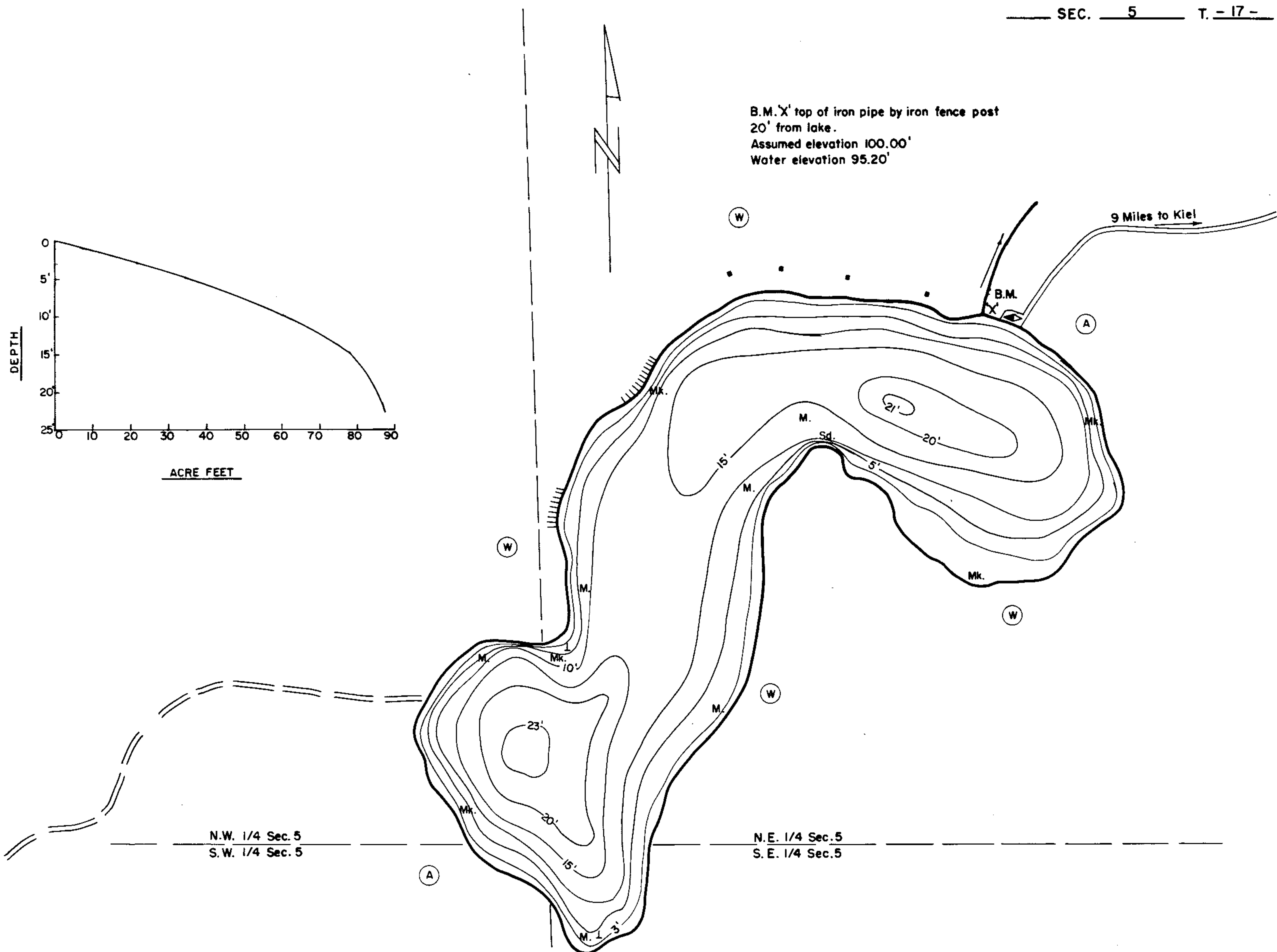

N.W. 1/4 Sec. 5  
S.W. 1/4 Sec. 5

N.E. 1/4 Sec. 5  
S.E. 1/4 Sec. 5

SPECIES OF FISH		
	Abundant	Rare
Muskie		
N. Pike	X	
Walleye		
L. M. Bass	X	
S. M. Bass		
Panfish	X	
Trout		

EQUIPMENT RECORDING SONAR MAPPED MAY 1964  
MO. YR.

- | TOPOGRAPHIC SYMBOLS   |                      | LAKE BOTTOM SYMBOLS |                         |
|-----------------------|----------------------|---------------------|-------------------------|
| (B) Brush             | Steep slope          | P. Peat             | Gr. Gravel              |
| (PW) Partially wooded | Indefinite shoreline | Mk. Muck            | R. Rubble               |
| (W) Wooded            | Marsh                | C. Clay             | Br. Bedrock             |
| (C) Cleared           | Spring               | M. Marl             | T Submergent vegetation |
| (P) Pastured          | Intermittent stream  | Sd. Sand            | Emergent vegetation     |
| (A) Agricultural      | Permanent inlet      | St. Silt            | Floating vegetation     |
| B.M. Bench Mark       | Permanent outlet     |                     |                         |
| (D) Dwelling          | Dam                  |                     |                         |
| (R) Resort            |                      |                     |                         |

WATER ELEV. 95.20'

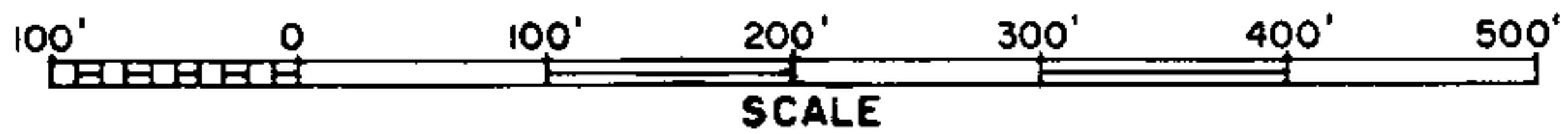

Access Access with Parking Boat Livery  
Field work by: H. Schmutz, F. Hilbert Drawn by: J. Roth

AREA 7.7 ACRES  
UNDER 3 FT. 11.7 %  
OVER 20 FT. 9.1 %  
VOLUME 87.4 ACRE FT.  
TOTAL ALK. 188 P.P.M.  
SHORELINE 0.5 MILES  
MAX. DEPTH 23 FEET

Source: Wisconsin Department of Natural Resources 608-266-2621  
Spring Lake – Manitowoc County, Wisconsin DNR Lake Map  
Date – May 1964 - Historical Lake Map - Not for Navigation  
A Public Document - Please Identify the Source when using it.